

PARAMETRY TECHNICZNE / TECHNICAL PARAMETERS

KAUSZA DO LIN DIN 6899B WIRE ROPE THIMBLE DIN 6899B

DOSTAWCA / SUPPLIER

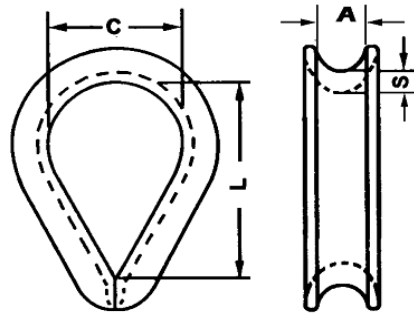

NR KONTROLNY
CONTROL NO.

07//2021

ROZMIAR/SIZE do liny/for wire	C [mm]	L [mm]	A [mm]	S [mm]				Masa/szt Weight/pc [kg]
3 mm	12.5	19.0	3.7	1.7				0.005
4 mm	13.3	20	4.8	1.7				0.008
5 mm	14.5	23	6	1.7				0.009
6 mm	16	24.5	7.5	2				0.017
8 mm	20.5	31.5	9.5	2				0.025
9 mm	25.5	39	12	2				0.032
10 mm	25	38	11	2				0.035
12 mm	28	44.5	13	3				0.067
13 mm	30.5	50	14.5	2.5				0.073
14 mm	31.5	52	16	2.5				0.085
16 mm	35.5	59	18.5	3				0.128
18 mm	40.5	63.5	21	4				0.229
20 mm	44.5	72.5	23.5	4				0.283
22 mm	51.5	80	24	4				0.329
24 mm	56.5	91.5	27	5				0.490
26 mm	62.5	99.5	29	5				0.556
28 mm	71	111.5	31	5				0.679
30 mm	71.5	126.5	34	6				0.967
32 mm	81.5	128.5	35.5	6				0.981
34 mm	97	155	37.5	6				1.073
36 mm	97	162.5	39.5	6.5				1.442
38 mm	105	185	42.5	6.5				1.638
40 mm	112	184	47	8.0				2.672
42 mm	112	181	48	8.0				2.362
45 mm	145	256.5	51.5	8.0				3.428
48 mm	145	234.5	55.5	8.0				4.198

MATERIAŁ / MATERIAL
C15

POKRYCIE / COVERING
ocynk / galv.

tolerancja wymiarów +/- 5%
dimensions tolerance +/- 5%

DATA / DATE

24.07.2021