

# Operation Book



**C300**

**Read Before Operation**

**USER MANUAL**

[www.samway.com](http://www.samway.com)

**SAMWAY**

## CONTENTS

1. INTRODUCTION .....	3
2. GENERAL PRECAUTIONS .....	4
3. EQUIPMENT .....	5
3.1 WARRANTY .....	5
3.2 IMPORTANT .....	5
4. MACHINE .....	6
4.1 IDENTIFICATION .....	6
4.2 DESCRIPTION .....	6
5. STARTING UP .....	7
5.1 PRELIMINARY STEPS .....	7
5.2 OPERATOR POSITION .....	7
5.3 STARTING UP .....	7
6. HOSE CUTTING .....	8
6.1 TO MAXIMIZE THE LIFE TIME OF THE CUTTING BLADE .....	8
6.2 DIFFERENT HOSE DIMENSIONS .....	8
7. MAINTENANCE .....	9
7.1 REPLACING THE CUTTING BLADE .....	9
7.2 AFTER EACH WORKING SHIFT .....	9
7.3 REGULAR MAINTENANCE .....	9
8. PICTURE .....	10
9. TECHNICAL DATA .....	11
10. SPARE PART LIST .....	12 - 16

# 1. Introduction

This information is the result of continuous, systematic data processing and technical tests recorded and validated by the manufacturer, in accordance with the internal procedures to ensure the safety of information: 2006/42/EC.

The information below is intended EXCLUSIVELY for specialized users, capable of interacting with the product with the utmost safety people, the machine and the environment, interpreting basic diagnostics of problems and malfunctions and performing simple checks and maintenance, in full compliance with the instructions given from the pages that follow and with current health and safety regulations.

The manual does not examine in depth the topics of disassembly and extraordinary maintenance, as these operations must always be carried out by our authorized Technical Service.

To handle the machine properly, it is necessary to keep the manual in good condition for the future. Contact the nearest authorized technical service if you need a new manual or more complete information.

Before each intervention to the machine or its packaging, read the instructions in the following manual very carefully.

**Every operator using the machine MUST read the following instructions before operating.**

SAMWAY Machine declines any responsibility for damage to persons, things or to the machine itself, arising from its incorrect use, negligence and superficial interpretations of safety concepts in this manual.

**This instruction manual should serve for the duration of the cutting machine's operating life and be available for at least 10 (ten) years. We recommend to keep it in a known and accessible place (possible together with other documents related to the machine).**

## 2. General precautions

Always make sure in advance that the minimum safety, placement and operating standards are respected, taking note of the environmental conditions, temperature, humidity, lighting, vibrations, suspended dust and the appropriateness of the area to be occupied.

The cutting machine is constructed to operate indoors (workshops, industries etc.) where there is no risk of explosion or fire.

Before cutting the first hose, make sure the cutting blade rotates in the correct direction (see rotation arrow) and that the hose is placed steady towards the adjustable cutting support. Also make sure that the hose is held steady so that there will be no risk of injuries or damages.

**When cutting machine, the cutting supports (2 pcs) must be used.**

Do not remove the information plates on the cutting machine. Make sure they are readable and that you are sure about their meaning. Should they deteriorate, replace them immediately by contacting only an authorized Technical Service.

**It is strictly forbidden to tamper with safety equipment and or devices.**

Dispose of processing waste in compliance with current regulations.

### **NOTE!**

Skilled personnel co-ordinated by authorized Technical Service must carry out any maintenance operations, except for those specifically described on the pages of this manual.

## 3. The equipment

Our stationary hose cutting machine is supplied ready to use (except for the plug), packed on a pallet.

### NOTE!

The packing material must be disposed according to current environmental protecting regulation.

### The machine is supplied initially with:

- Cutting blade 300x3x50 mm, part No: 9003-00-03
- 2 pcs of prebend pins
- Instruction manual
- Certificate regarding agreement according to CE-standards

### 3.1 Warranty

The cutting machine is guaranteed for one (1) year following the date of purchase; the warranty is valid only if all of the instructions listed on the warranty certificate and in this manual are fully complied with.

### NOTE!

When unpacking the cutting machine, make sure that the machine is in perfect condition and that the package contains the parts described. SAMWAY Machine does not respond for errors or missing parts not reported to SAMWAY Machine following eight (8) days after shipment.

### 3.2 Important

The hose cutting machine is designed, manufactured and protected for cutting 1- and 2-layers hydraulic hose with dimension from 3-16" up to 2". Any other use is excluded by SAMWAY Machine, who shall be exempt from any liability for damage to people, property or the machine itself, caused by improper use. Do not leave the cutting machine idle running for longer periods, without cutting anything.

**Do not cut solid steel, wood or other unknown material, that can cause damage to people, property or the machine itself.**

## 4. The machine

### 4.1 Identification

The information for identifying the machine is found on the plates, located outside of the cutting machine. This essentially includes:

- Manufacturer
- Serial number
- Year of manufacture
- Voltage
- Hertz(Hz)
- Amperes (A)
- Weight

The CE- approval plate is located at the back of the machine, on the top to the right.

#### **NOTE!**

It is strictly forbidden to remove or damage the plate. Should this happen, always contact an authorized Technical Service only.

For any information and/or technical explanations regarding the cutting machine, always indicate:

- Model
- Edition and preparation date of the instruction manual
- Serial number

### 4.2 Description

The hose cutting machine consists of one unit, equipped with a handle which is manually manoeuvred and flap doors that are pressed away by the hose during the cutting process. The unit is also equipped with a connection for a smoke evacuator (option) and as standard with a smooth cutting blade assembled on the machine except the Mini Cut 12V. Standard for 12V is toothed blade.

The hose cutting machine must only be used for hydraulic hose compatible with the specifications below. Follow the environmental conditions and limitations recommended by SAMWAY Machine and current health and safety regulations.

#### **NOTE!**

The descriptions includes the use for which the machine has been designed, built and protected. Any other use or failure to comply with the technical parameters listed below, may constitute a hazard to people and/or property.

## 5. Starting - up

### 5.1 Preliminary steps

#### **Important!**

It is essential to determine size measurements and placement in advance in order to ensure safe placement, running and emergency actions within the surrounding environment. These conditions should be respected beginning with the preliminary stages, before cutting begins.

- Place the machine on a steady and flat foundation.
- Check that the cutting blade can rotate freely.
- Check that the handle can move freely back and forward.
- Check that the cutting blade is tightened.

#### **NOTE!**

Before plugging-in the machine, make sure that the line voltage corresponds to the voltage indicated on the machine. If the voltage is 12V, connect red to positive pole and blue to negative pole. Always use goggles and earplugs when working with the machine.

### 5.2 Operator position

The placement of the machine in relation to the operator's position must make it possible to observe the result of the operation and maintain safety conditions. During this stage, make sure that the start/stop button and safety switch not are blocked and that there is sufficient visibility and lightning on the machine, the surrounding area and base.

### 5.3 Starting - up

Release the emergency button by turning it clockwise. Press the START-button and press the handle forward for cutting.

#### **Caution!**

Check the direction of rotation (the upper edge of the cutting blade shall rotate towards the cutting table). If the machine starts to vibrate heavily, stop the machine immediately and check the reason for the vibrations.

## 6. Hose cutting

### 6.1 To maximize the lifetime of the cutting blade

1. The ten first cuts on a new cutting blade should be cut with a very low feed speed.
2. After these ten first cuts, the cut should be fast but without overloading of the motor.
3. Do not overheat the cutting blade.

### 6.2 Different hose dimensions

#### **Important!**

#### **When cutting ...**

... hoses of dimension 3-16" - 1/2" must the prebend supports always be used and put in the two inner holes. Min. cutting length 150 mm.

... hoses of dimension 5-8" - 1" must the prebend supports always be used and put in the two middle holes. Min. cutting length 250 mm.

... hoses of dimension 1 1/4" - 2" must the prebend supports always be used and put in the two outer holes. Min. cutting length 300 mm.

**Now the machine is ready for cutting these hose dimensions.**



## 7. Maintenance

### 7.1 Replacing the cutting blade

#### **Warning !**

Always use protective gloves when changing the cutting blade.

- Disconnect the electric supply.
- Open the lid on the back side and the lid on the right hand side.
- Take away the cut table by loosening four screws.
- Loosen the hexagon headed screw by using a 6 mm hexagon head socket wrench.
- The cutting blade is now loose. Dismantle the old blade and assemble a new one.
- Mount the new blade and screw the adapter plate tightly with the center bolt.
- Moment of torsion is 9,8 Nm for M6 and 24 Nm for M8.

#### **Important !**

Start the cutting machine and check that no vibrations occur. Make a test cut to make sure that the cutting blade is thoroughly tightened.

### 7.2 After each working shift

- Press the emergency stop button and remove cutting waste.

### 7.3 Regular maintenance

- Make sure that the cutting blade is in good condition, that no cracks have occurred.
- Open the black lid and clean the machine. Remove cutting waste.
- Check that there are no defects on electrical connections or cables.

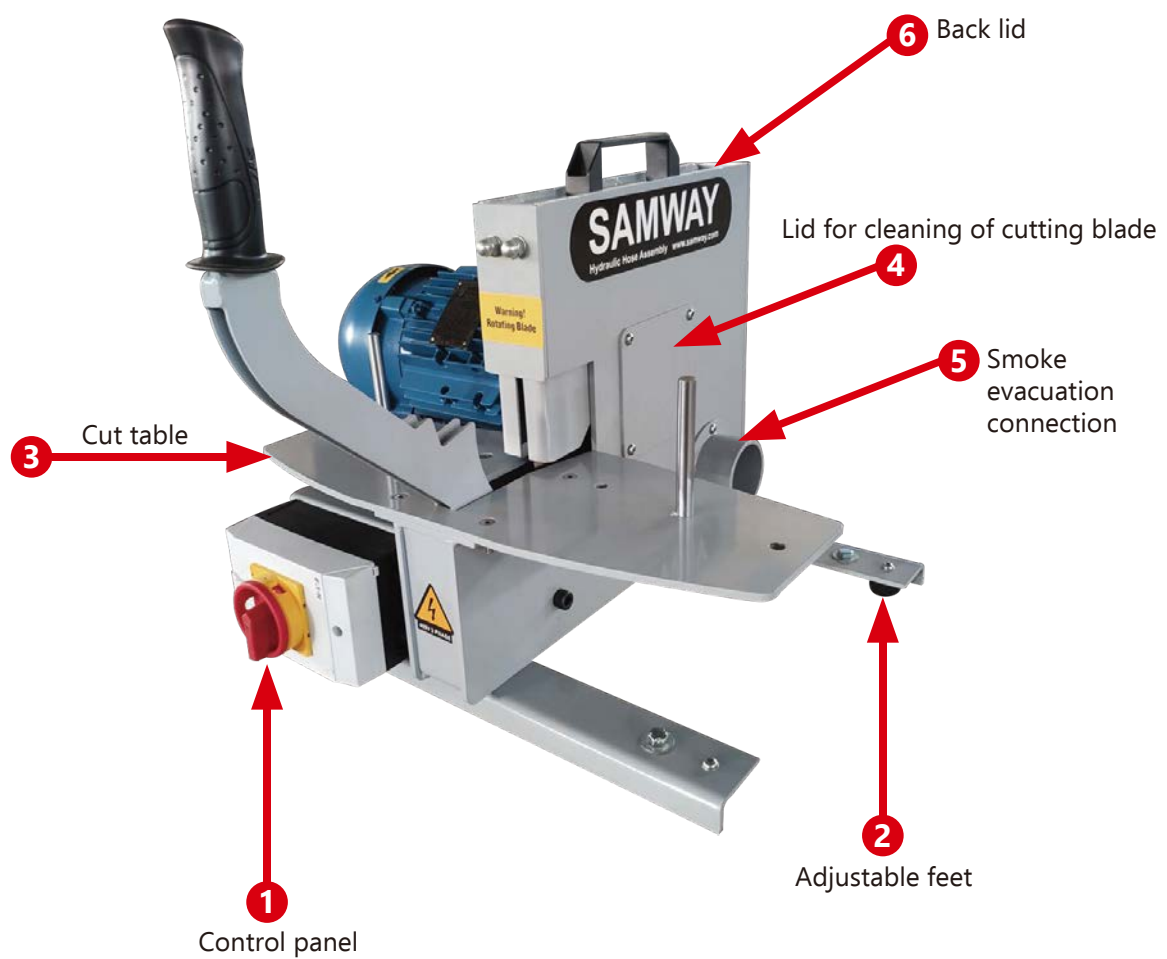
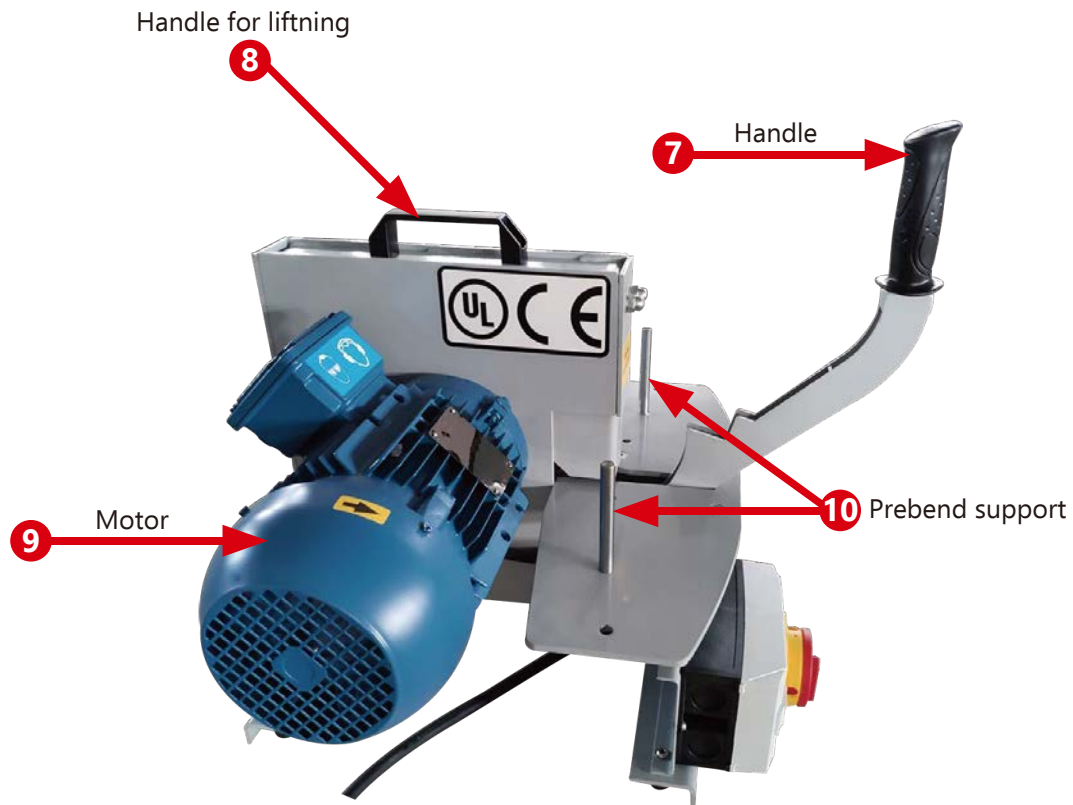

Technical Data

- Benefit:
- Compact Design
  - Hand Cutting
  - Up to 2" 4SP Hydraulic Hose
  - CE Approved



SAMWAY C300

Maximum Cutting .....	2" 4SP Hydraulic Hose
Motor .....	3KW
Cutting .....	HAND OPERATION
Blade .....	300*50*3mm
Blade Toothed .....	Optional
Brake Motor .....	Optional
L*W*H .....	450*400*430 mm
Weight .....	45 KG

WUXI SAMWAY CO.LTD  
whatsapp +86 138 120 22928 ; SKYPE : samway.company  
Tel: 0086-510 8378 8458 ; Mobile: 0086 13812022928  
samwaysales@gmail.com ; www.samway.com



10. Spare part list

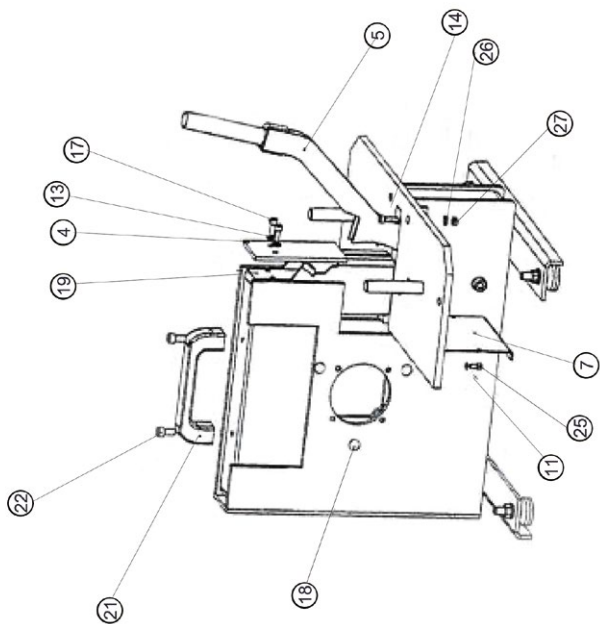
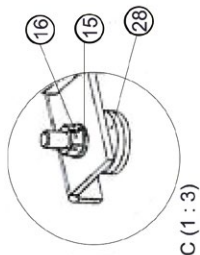
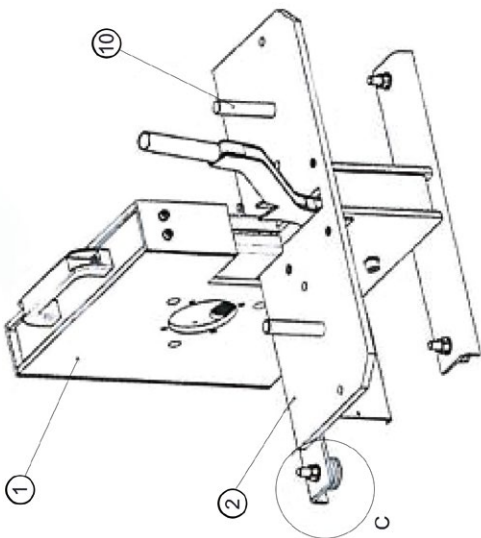
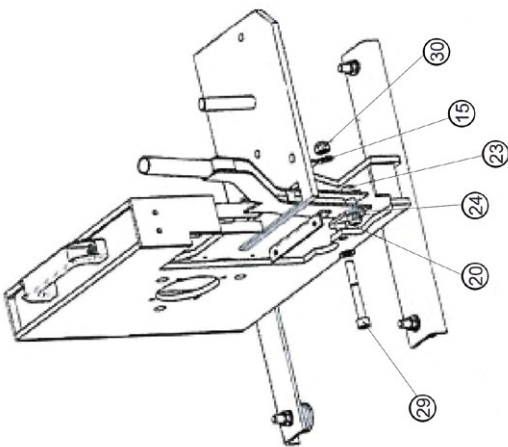
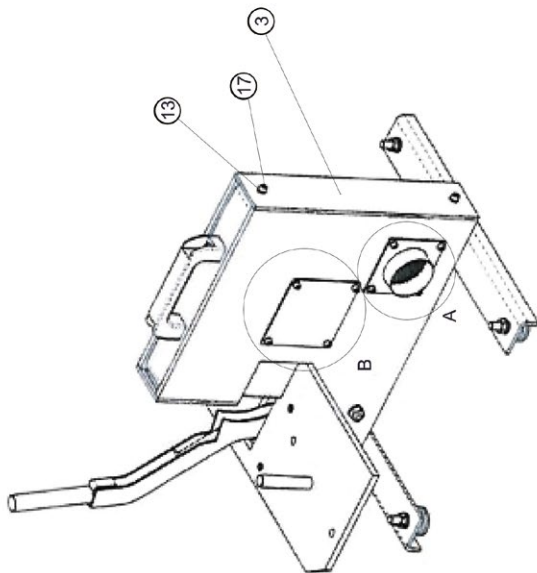
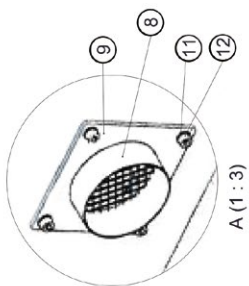
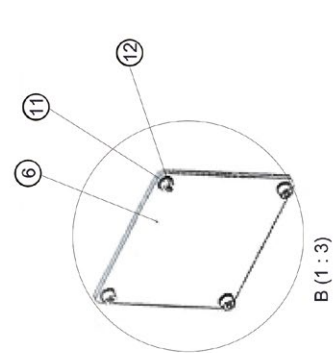

ITEM NO.	QTY	PART NO.	DESCRIPTION
1	1	S023003	Machine body
2	1	D023012	Table
3	1	D023002	Back sheet
4	1	S023005	Blade cover
5	1	S023002	Arm
6	1	D023013	Side plate
7	1	D023024	Holder, electric box
8	1	T0041	Exhaust
9	1	D023025	Holder, exhaust
10	2	D023023	Bend support C300
11	10	302225410	Washer ISO 7089:2000 5-fzb
12	8	10021400501271	Hex. socket head cap screw ISO 4762 M5x12-8.8-fzb
13	4	T0028	BRB 6 FZB
14	4	T0025	MC65 6x20 8.8 FZB
15	6	302010410	Washer ISO 7089:2000 10-fzb
16	4	T0075	M10M FZB
17	4	T0026	MC65 6x16 8.8 FZB
18	3	T0330	Bindpropp. 8 1.5/11 Gra
19	1	D023032	Spring support
20	1	S023008	Link
21	1	T0331	Handle WN130 132-MB
22	2	10231400801621	Hex. socket head screw ISO - M8x16 - 8.8
23	1	MC65 ISO 4762 - M10x40	Washer ISO 4762 - M10x40
24	1	T0329	MC65 ISO 4762 - M10x40
25	2	MC65x10 Skruv	MC65x10 Lock King
26	4	M6M6	Washer ISO 7089:2000 6-fzb
27	4	T0331	Hex.nut ISO 4032 6-8-fzb
28	4	T0331	Machine foot 037 M10x30. Kompl.
29	1	MC65 ISO 4762 - M10x80	MC65 ISO 4762 - M10x80
30	1	NU M6M 10 Lock King	NU M6M 10 Lock King



10. Spare part list

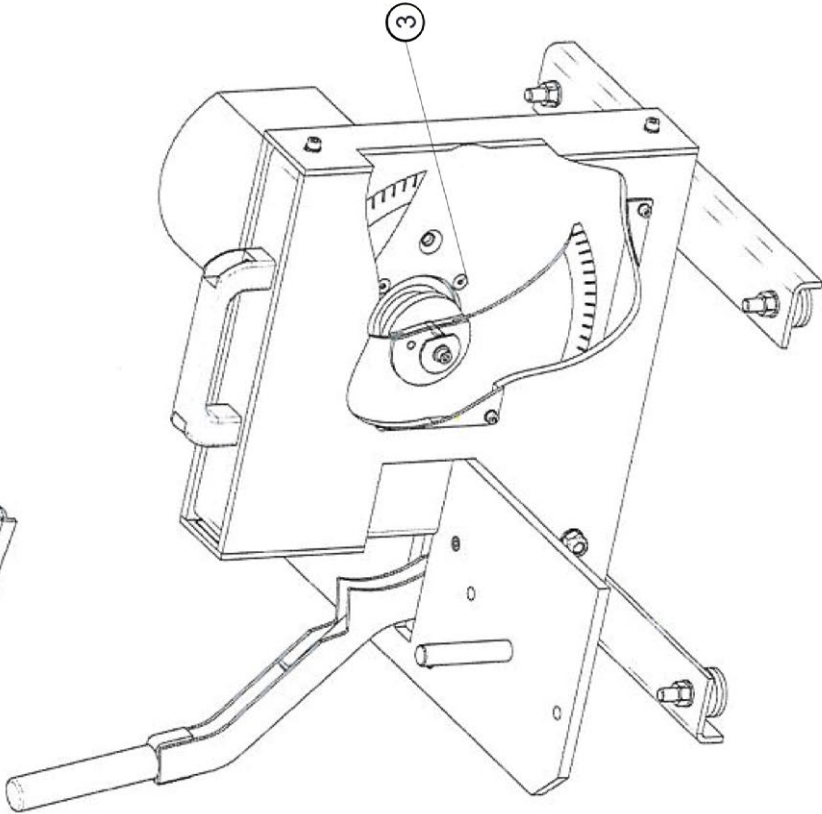
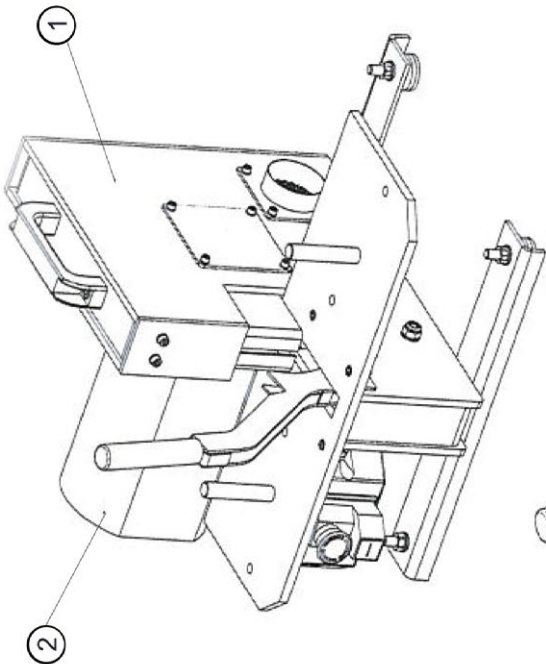
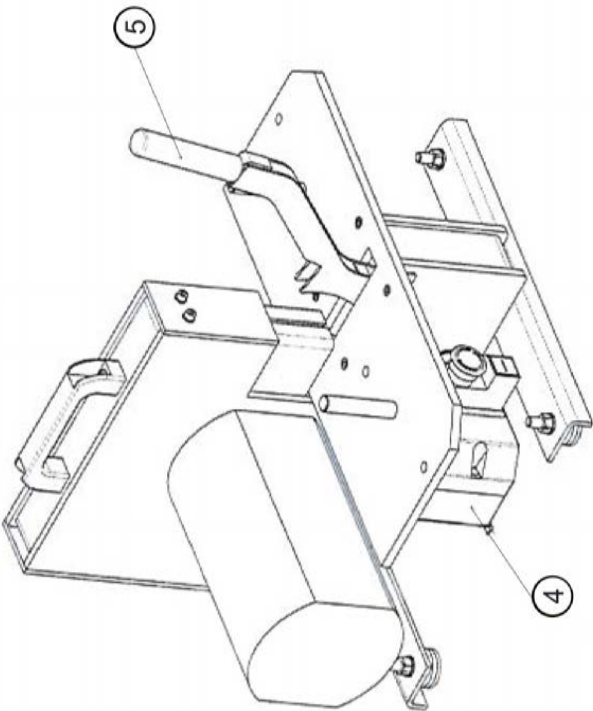

ITEM NO.	QTY	PART NO.	DESCRIPTION
1	1	S023004	Base Assembly 1
2	1	S023006	Cutting C300 200-400V
3	4	T010	MF6S 6x30 FZB
4	1	S023009	Electric box
5	1	T0325	Plastic handle





10. Spare part list

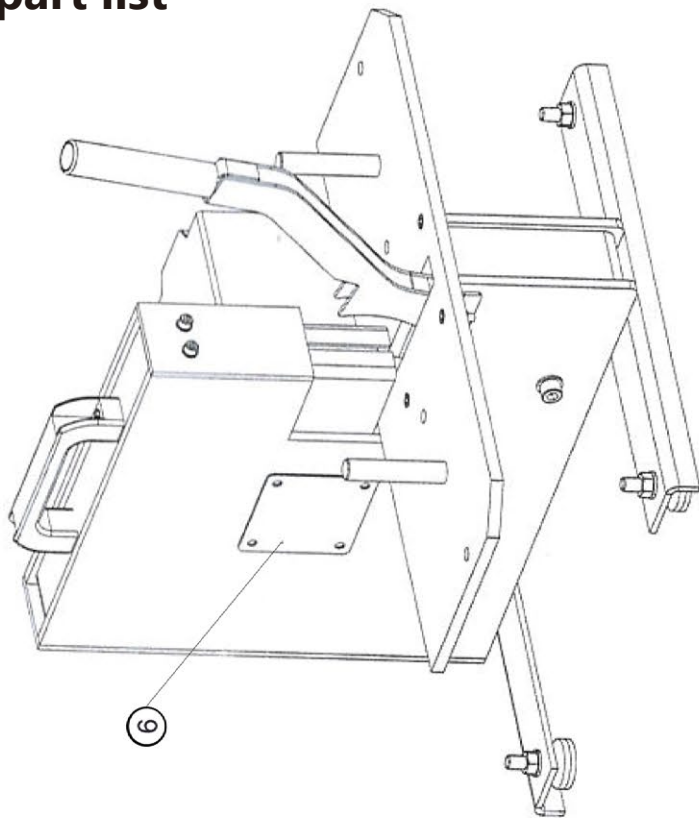
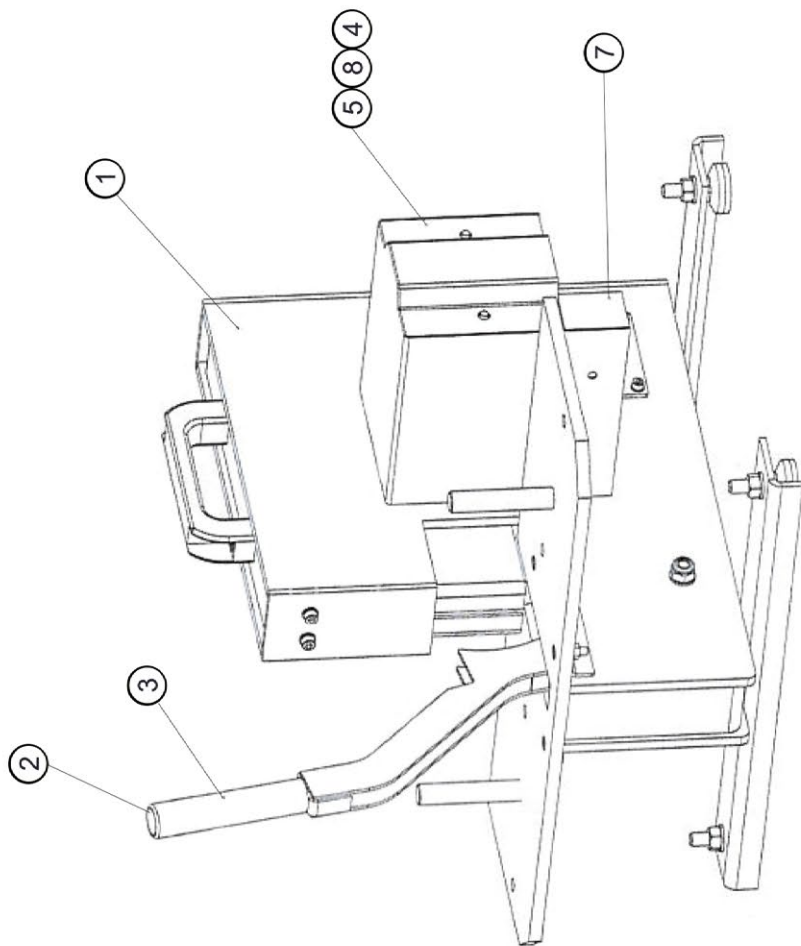

ITEM NO.	QTY	PART NO.	DESCRIPTION
1	1	S023004	Base Assembly 1
2	1	T0327	Switch, 12V
3	1	T0325	Plastic handle
4	1	D023040	Plate
5	1	S023014	Hood
6	1	D023044	Plate
7	1	E0097	Relay 12V, 180 Amp, 4Term
8	1	S023015	Cutting unit 12V, 3kW



10. Spare part list

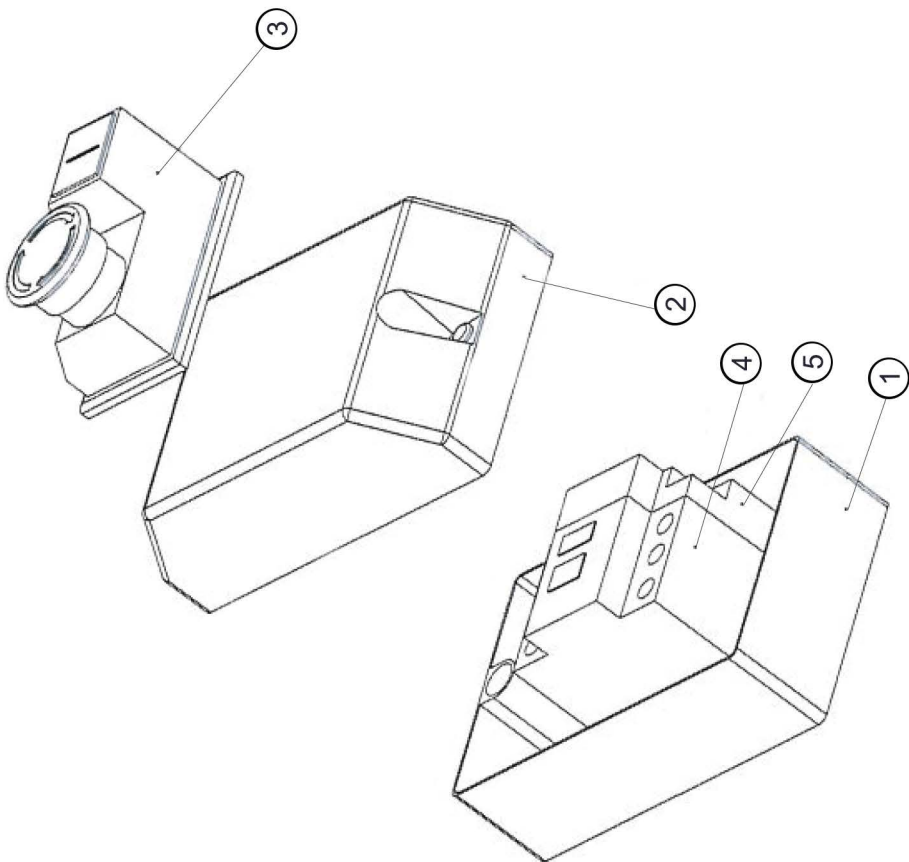
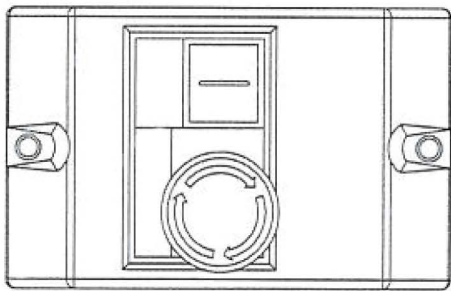

ITEM NO.	QTY	PART NO.	DESCRIPTION
1	1	E0082	Electric box, box
2	1	E0083	Electric box, Cover
3	1	E0085	Switch
4	1	E0086	Motor circuit breaker
5	1	E0087	Voltage trips



10. Spare part list

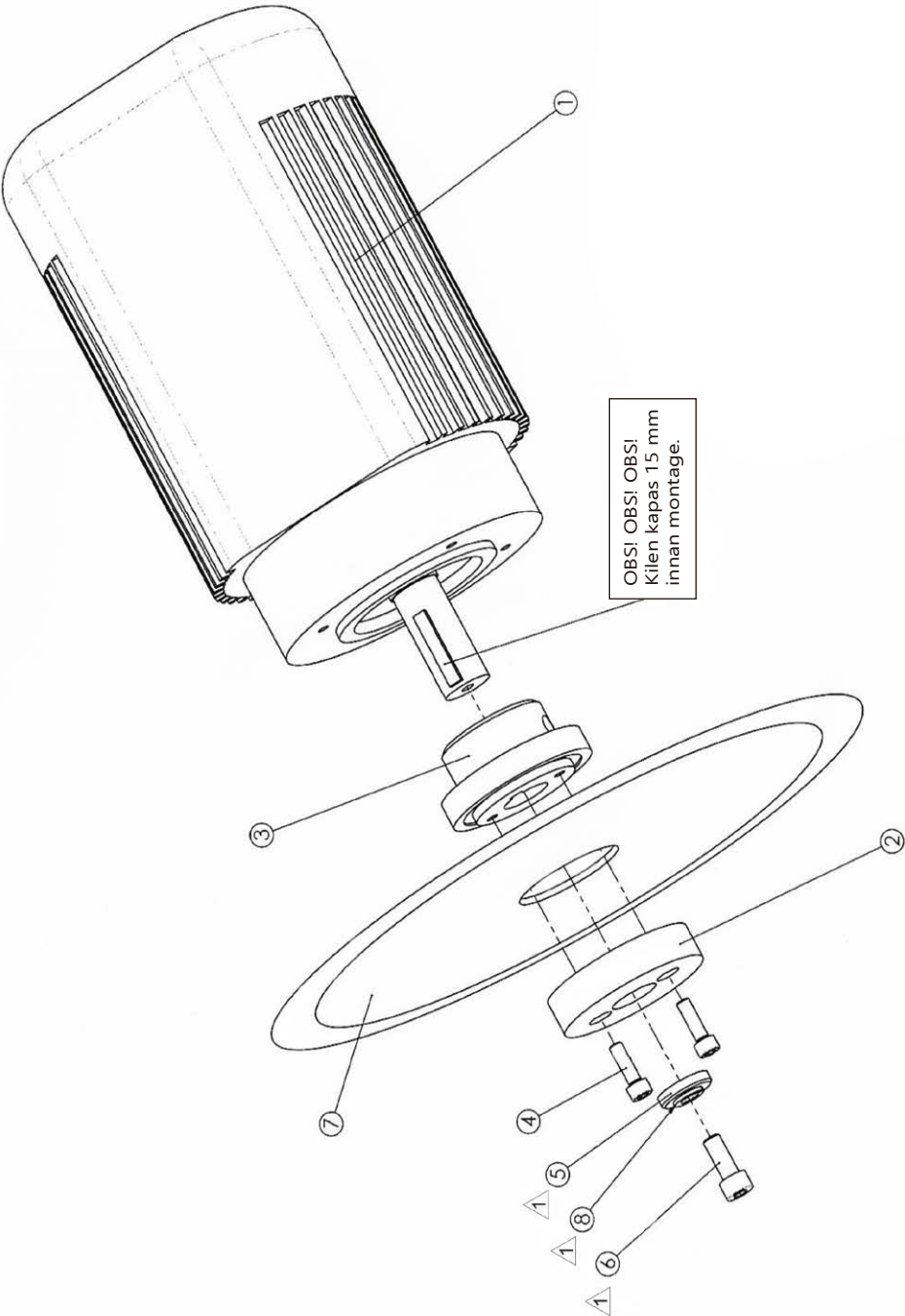

Pos.	Artiklnummer Part number	Ritningsnummer Drawing number	DESCRIPTION	Antal Qty
1		E0011	Motor 3fas 3KW mc	1
2	90180310	D023019	Outer carrier plate 200-400 V	1
3	90180311	D023018	Inner carrier plate 200-400 V	1
4	90175027	T0025	MC6S 6x20 8.8 FZB	2
5	90175057	WA TBR5B 8.4x26x5	Washer	1
6	90175007	MC6S 8x20		1
7	90030005	T0337	Cutting blade 300-50	1
8	90175263	WA FBB M8		1

