



## FEATURES

Full Automatic Precision Control  
 Energy Saving and Safety Operation  
 CE Approved

## OPTIONS

Backstop Device  
 Control by Pressure  
 110V/220V 1 Phase  
 230V/440V/480V 3 Phase

# PE58

## TECHNICAL DATA

Max Hydraulic Hose	2"6SP or 4"Industrial Hose
Crimping Range (mm) <sup>1)</sup>	4-116
Die Type	P32
Master Die Length (mm)	100
Max Opening (mm) <sup>2)</sup>	+52
Motor (KW)	5.5(400V 3 Phase)
Crimping Force (KN)	3200
Crimpings Per Hour	800
Noise Level (dBA)	65
Protection Class	IP56

## DIMENSIONS (LxWxH)

Machine (mm)	650x550x700
Machine (inch)	25.6x21.7x27.6
Packaged (mm)	750x650x850
Packaged (inch)	29.5x25.6x33.5

## WEIGHT

Machine (kg/lbs)	550/1213
Packaged (kg/lbs)	580/1279

\* ACCORDING TO THE FITTING.

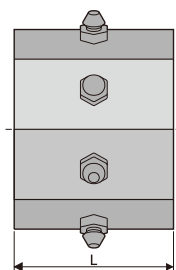
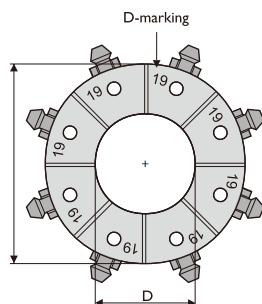

- 1) With standard dies. Crimping range can be increased with special dies.
- 2) Maximum opening is the total die travel. Add this value to the minimum crimping diameter of the die set used. The result is the maximum opening of the machine with die set in place.

## CONTROL

Advanced Programmable Chip

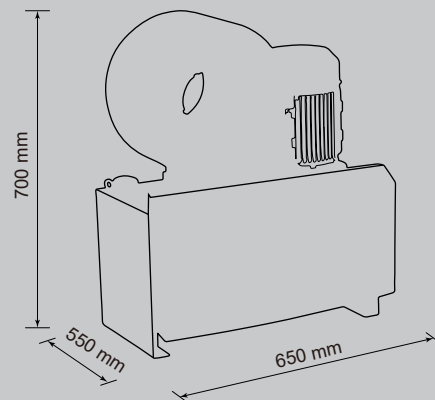

## DIE SET 140-SERIES

DieSetNo	D (mm)	L (mm)	Crimp. range (mm)
18860/84	84	110	84.0-92.0
18860/92	92	110	92.0-100.0
18860/100	100	110	100.0-108.0
18860/108	108	110	108.0-116.0
18860/116	116	110	116.0-124.0

## DIE SET 32-SERIES

DieSetNo	D (mm)	L (mm)	Crimp. range (mm)
*18506/10	10	55	10.0-12.0
*18506/12	12	55	12.0-14.0
18506/14	14	55	14.0-16.0
18506/16	16	55	16.0-19.0
18506/19	19	55	19.0-22.0
18506/22	22	70	22.0-26.0
18506/26	26	70	26.0-30.0
18506/30	30	70	30.0-34.0
18506/34	34	75	34.0-39.0
18506/39	39	75	39.0-45.0
18506/45	45	90	45.0-51.0
18506/51	51	90	51.0-57.0
18506/57	57	100	57.0-63.0
18506/63	63	110	63.0-69.0
18506/69	69	110	69.0-75.0
*18506/74	74	110	74.0-80.0
*18506/78	78	110	78.0-87.0

\* Optional die sets at additional cost

Products images & Specifications may alter prior official notice at any time.