



# FP170/FP175

### TECHNICAL DATA

Max crimping dia (mm/inch) <sup>1)</sup>	320/12.60
Max crimping dia with master dies (mm/inch)	330/13
Max. crimping force (kN)	6600/8600(FP175)
Max. crimping force (tonnage)	660
Cycle time 10 mm (s) <sup>2)</sup>	3.1
Hydraulic hose size (inch)	10 *
Industrial hose size (inch)	12.60 *
Die set series	32 <sup>3)</sup> / 160 <sup>3)</sup> / 170
Max. opening (mm) <sup>4)</sup>	+150
Max. opening without dies (mm)	470
Master die D/L (mm)	320/190
Master die D/L (inch)	12.60/8.66
Motor Power (KW/HP)	15/20(400V 3 Phase)
Oil tank volume	250 L

### DIMENSIONS (LxWxH)

Machine (mm)	1800x1000x1500
Machine (inch)	70.9x39.4x59.1
Packaged (mm)	1900x1100x1700
Packaged (inch)	74.8x43.3x66.9
Hydraulic Unit (mm)	900x700x1300
Hydraulic Unit (inch)	35.4x27.6x51.2
Packaged (mm)	1045x800x1405
Packaged (inch)	41.1x31.5x55.3

### WEIGHT

Machine (kg/lbs)	3500/7716
Packaged (kg/lbs)	3800/8378
Hydraulic Unit (kg/lbs)	500/1102
Packaged (kg/lbs)	550/1213

\* ACCORDING TO THE FITTING.

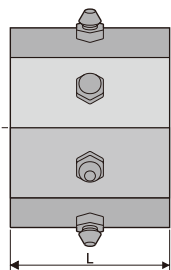
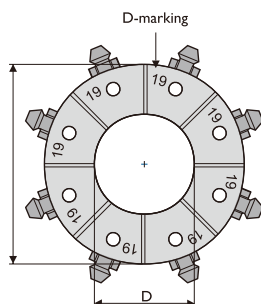

- 1) With standard dies. Crimping range can be increased with special dies.
- 2) Theoretical with 10 mm cycle.
- 3) With adapter dies
- 4) Maximum opening is the total die travel. Add this value to the minimum crimping diameter of the die set used. The result is the maximum opening of the machine with die set in place.

### FEATURES

- Siemens Touch Control
- Designed for Mass Production
- Large Opening up +150mm
- Low crimping center 650mm above ground
- CE Approved

### OPTIONS

- Back stop device
- Pressure Control
- Camera and monitor
- Customized die sets
- Customized voltage
- Customized Logo
- 110V/220V 1 Phase
- 230V/440V/480V 3 Phase

### CONTROL

Siemens Touch Control

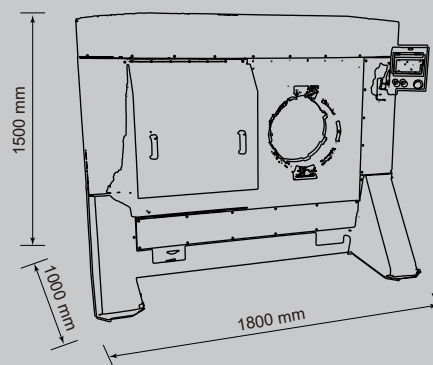

### DIE SET 170-SERIES

DieSetNo	D(mm)	L(mm)	Crimp. range(mm)
405060/205	205	220	205.0-220.0
405060/220	220	220	220.0-235.0
405060/235	235	220	235.0-250.0
405060/250	250	220	250.0-270.0
405060/270	270	220	270.0-290.0
405060/290	290	220	290.0-320.0

### DIE SET 160-SERIES

DieSetNo	D(mm)	L(mm)	Crimp. range(mm)
18852/126	126	116	126.0-136.0
18852/136	136	116	136.0-146.0
18852/146	146	116	146.0-156.0
18852/156	156	116	156.0-166.0
18852/166	166	116	166.0-178.0
18852/178	178	116	178.0-190.0
18852/190	190	116	190.0-202.0

### DIE SET 140-SERIES

DieSetNo	D(mm)	L(mm)	Crimp. range(mm)
18860/84	84	110	84.0-92.0
18860/92	92	110	92.0-100.0
18860/100	100	110	100.0-108.0
18860/108	108	110	108.0-116.0
18860/116	116	110	116.0-124.0

\* Optional die sets at additional cost

Products images & Specifications may alter prior official notice at any time.