

P320

TECHNICAL DATA

Industrial Hose	10"
Max Hydraulic Hose	4"6SP
Crimping Range (mm)	4-290
Die Type	P32
Crimping Speed Second	12
Max Opening (mm) ¹⁾	+60
Motor Power (KW/HP) ¹⁾	11.0/14.7(400V 3 Phase)
Crimping Force (KN)	2800
Crimpings Per Hour	450
Foot pedal	Included
Noise Level (dBA)	65
Protection Class	IP56

DIMENSIONS (LxWxH)

Machine (mm)	950x1000x1450
Machine (inch)	37.4x39.4x57.1
Packaged (mm)	1150x1150x1600
Packaged (inch)	45.3x45.3x63.0

WEIGHT

Machine (kg/lbs)	1800/3968
Packaged (kg/lbs)	1900/4189

* ACCORDING TO THE FITTING.

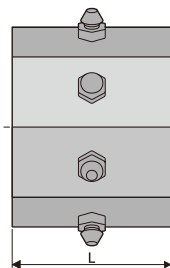
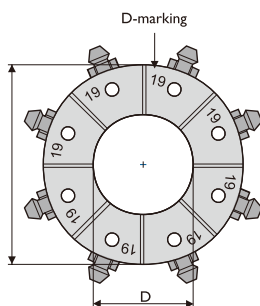

1) Maximum opening is the total die travel. Add this value to the minimum crimping diameter of the die set used. The result is the maximum opening of the machine with die set in place.

FEATURES

Full Automatic Control with Foot pedal
 10" Industrial Hose
 Energy Saving and Safety Operation

OPTIONS

Die Rack
 Quick Change Tool
 Backstop Device
 Control by Pressure
 110V/220V 1 Phase
 230V/440V/480V 3 Phase

CONTROL

Digital Control

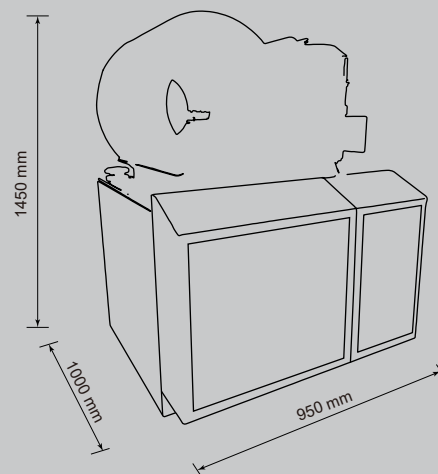

Products images & Specifications may alter prior official notice at any time.