

zakuwarka do węży



FEATURES

Compact Design for use in a Van or Truck
 12V/24V DC by Battery Power
 Up to 1 1/4"SP hydraulic hose

OPTIONS

12V/24V DC

P20DC

TECHNICAL DATA

Max crimping dia (mm/inch) ¹⁾	61/2.40
Max crimping dia with master dies (mm/inch)	94/3.7
Max crimping force (KN)	1370
Max crimping force (tonnage)	137
Cycle time 10 mm (s) ²⁾³⁾	4
Hydraulic hose size (inch)	1 1/2 *
Industrial hose size (inch)	2.40 *
Die set series	20
Max opening (mm) ⁴⁾	+25
Max opening without dies (mm)	109
Master die D/L (mm)	84/80
Master die D/L (inch)	3.31/3.15
Motor Power (kW/HP) ³⁾	3.0/4.0 1.5/2.0 (400V 3 Phase)
Oil tank volume	40 L

DIMENSIONS (LxWxH)

Machine (mm)	820x700x650
Machine (inch)	32.3x27.6x25.6
Packaged (mm)	920x800x800
Packaged (inch)	36.2x31.5x31.5

WEIGHT

Machine (kg/lbs)	220/485
Packaged (kg/lbs)	240/529

* ACCORDING TO THE FITTING.

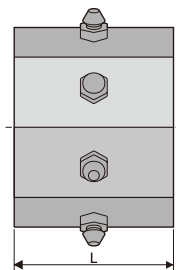
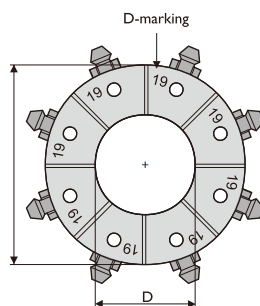

CONTROL

Micro Control

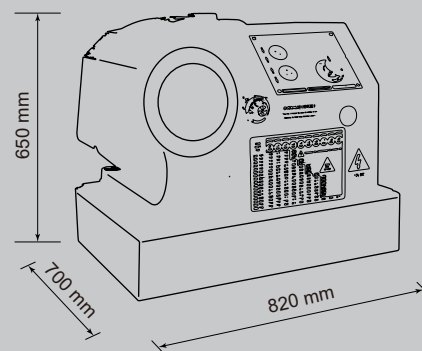

DIE SET 20-SERIES

DieSetNo	D (mm)	L (mm)	Crimp. range (mm)
*18506/10	10	60	10.0-12.0
*18506/12	12	60	12.0-14.0
18506/14	14	60	14.0-16.0
18506/16	16	60	16.0-19.0
18506/19	19	60	19.0-22.0
18506/22	22	75	22.0-26.0
18506/26	26	75	26.0-30.0
18506/30	30	75	30.0-34.0
18506/34	34	80	34.0-39.0
18506/39	39	80	39.0-45.0
18506/45	45	90	45.0-51.0
*18506/51	51	90	51.0-57.0
*18506/57	57	100	57.0-63.0
*18506/63	63	100	63.0-69.0
*18506/69	69	100	69.0-75.0
*18506/74	74	110	74.0-80.0
*18506/78	78	110	78.0-87.0

* Optional die sets at additional cost

1) Maximum opening is the total die travel. Add this value to the minimum crimping diameter of the die set used. The result is the maximum opening of the machine with die set in place.

2) 3-phase/1-phase

Products images & Specifications may alter prior official notice at any time.