



## FP120

### TECHNICAL DATA

Max crimping dia (mm/inch) <sup>1)</sup>	87/3.42
Max crimping dia with master dies (mm/inch)	109/4.3
Max. crimping force (kN)	2800
Max. crimping force (tonnage)	280
Cycle time 10 mm (s) <sup>2)</sup>	1.8 (S-model: 1.6)
Hydraulic hose size (inch)	2 *
Industrial hose size (inch)	3.42 *
Die set series <sup>3)</sup>	32
Max. opening (mm) <sup>4)</sup>	+78
Max. opening without dies (mm)	167
Master die D/L (mm)	99/97
Master die D/L (inch)	3.90/3.82
Motor Power (KW/HP)	4/5.4(400V 3 Phase)
Oil tank volume	135 L

### DIMENSIONS (LxWxH)

Machine (mm)	860x1000x1600
Machine (inch)	33.9x39.4x63.0
Packaged (mm)	1050x1050x1780
Packaged (inch)	41.3x41.3x70.1

### WEIGHT

Machine (kg/lbs)	1250/2756
Packaged (kg/lbs)	1400/3086

\* ACCORDING TO THE FITTING.

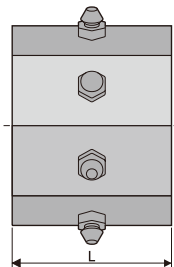
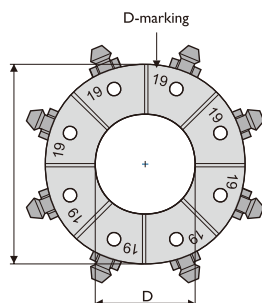

- 1) With standard dies. Crimping range can be increased with special dies.
- 2) Theoretical with 10 mm cycle.
- 3) Hydraulic hose / industrial hose.
- 4) Maximum opening is the total die travel. Add this value to the minimum crimping diameter of the die set used. The result is the maximum opening of the machine with die set in place.

### FEATURES

- Precision Digital Control
- Quick Change Tool and Die rack
- Designed for Mass Production
- Energy Saving and Fast Crimping
- CE Approved

### OPTIONS

- Siemens Touch Control
- Back stop device
- Pressure Control
- Camera and monitor
- Customized die sets
- Customized voltage
- Customized Logo
- 110V/220V 1 Phase
- 230V/440V/480V 3 Phase

### CONTROL

Precision Digital Control

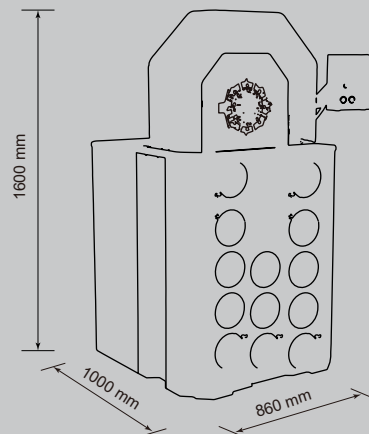

### DIE SET 32-SERIES

DieSetNo	D (mm)	L (mm)	Crimp. range(mm)
*18506/10	10	55	10.0-12.0
*18506/12	12	55	12.0-14.0
18506/14	14	55	14.0-16.0
18506/16	16	55	16.0-19.0
18506/19	19	55	19.0-22.0
18506/22	22	70	22.0-26.0
18506/26	26	70	26.0-30.0
18506/30	30	70	30.0-34.0
18506/34	34	75	34.0-39.0
18506/39	39	75	39.0-45.0
18506/45	45	90	45.0-51.0
18506/51	51	90	51.0-57.0
18506/57	57	100	57.0-63.0
18506/63	63	110	63.0-69.0
18506/69	69	110	69.0-75.0
*18506/74	74	110	74.0-80.0
*18506/78	78	110	78.0-87.0

\* Optional die sets at additional cost

Products images & Specifications may alter prior official notice at any time.